

**PHASE 1 - CURRENTLY UNDER CONSTRUCTION.**

CONNECT TO EXISTING 200mmØ WATERMAIN

EXISTING 200mmØ PH 1

BULK FLOW METER IN ACCORDANCE WITH IW STD-W-26F

BULK FLOW METER IN ACCORDANCE WITH IW STD-W-26A

32mm Ø ID HDPE SDR17

64mm Ø ID HDPE SDR17

AREA WITH SIGNIFICANT ARCHAEOLOGICAL REMAINS

LEGEND	
PROPOSED 150mm ID HDPE SDR-17 WATERMAIN	
PROPOSED 100mm ID HDPE SDR-17 WATERMAIN	
EXISTING WATERMAIN	
PROPOSED HYDRANT	
WASHOUT HYDRANT	
PROPOSED SLUICE VALVE	
BULK METER	
PROPOSED SCOUR VALVE	
PROPOSED AIR VALVE	
SCOUR CHAMBER	
PROPOSED BOUNDARY BOX	

- NOTES**
- NO PART OF THIS DRAWING MAY BE REPRODUCED OR TRANSMITTED IN ANY FORM OR STORED IN ANY RETRIEVAL SYSTEM OF ANY NATURE WITHOUT THE WRITTEN PERMISSION OF AKM DESIGN AS COPYRIGHT HOLDER, EXCEPT AS AGREED FOR USE ON THE PROJECT FOR WHICH THE DRAWING IS ORIGINALLY ISSUED.
  - ALL DIMENSIONS ARE IN m UNLESS OTHERWISE NOTED.
  - THE CONTRACTOR SHALL CHECK ALL DIMENSIONS PRIOR TO COMMENCEMENT OF CONSTRUCTION. DISCREPANCIES SHALL BE REPORTED TO THIS OFFICE IN WRITING.
- WATERMAIN**
- HANDLING, LAYING, TESTING AND STERILIZATION OF WATERMAIN PIPEWORK TO BE IN ACCORDANCE WITH IRISH WATER & LOCAL AUTHORITY REQUIREMENTS.
  - ALL PROPOSED WATERMAINS TO BE HDPE MATERIAL TYPE PE-80 AND SDR-17 UNLESS OTHERWISE STATED AND IN COMPLIANCE WITH SECTION 3.9 OF CODE OF PRACTICE
  - CONCRETE ANCHOR BLOCKS AT DEAD ENDS, TEES, BOTH SIDES OF SLUICE VALVES AND AT ALL BENDS OVER 11.25°.
  - MIN. COVER TO CROWN OF WATERMAIN TO BE 900mm.
  - HYDRANTS TO IS EN 14339, IS EN 1074 PART 6 AND B.S. 750 AND TO BE TYPE 2 HAVING AN 80MM DIAMETER FLANGE PN16 RATED TO IRISH WATER REQUIREMENTS.
  - HYDRANTS, AIR VALVES, SLUICE VALVES AND SCOUR VALVES SHALL BE INSTALLED IN CHAMBERS SUITABLY SIZED TO ACCOMMODATE THE FITTING AND ALLOW ACCESS FOR INSPECTION AND MAINTENANCE. THEY SHALL HAVE MINIMUM PLAN AREA OF 600MM X 600MM.
  - DEPTH TO HYDRANT OUTLET NOT TO EXCEED 250mm FROM FINISHED GROUND LEVEL.
  - SLUICE VALVES TO BE LOCATED IN CHAMBER AND TO BE DOUBLE FLANGED TO IS EN 1074 PART 1 AND 2. DEPTH OF SLUICE VALVE GAP SHALL BE WITHIN 300MM OF FINISHED GROUND LEVEL.
  - TEES, BOTH SIDES OF SLUICE VALVES AND WATERMAIN UNDER ROADS TO BE BACKFILLED USING SELECTED GRANULAR MATERIAL.
  - NO PART OF ANY BUILDING SHALL BE CLOSER THAN 3m TO A WATERMAIN OR MORE THAN 46m FROM THE NEAREST HYDRANT.
  - WATERMAINS SHALL BE LOOPED OR INTERCONNECTED NO DEAD ENDS ARE TO BE USED.
  - BOUNDARY BOXES SHALL BE LOCATED 225MM FROM EDGE OF PROPERTY BOUNDARY AND FITTED WITH A CLASS B OR CLASS C COVER TO BS 5834.
  - REFER TO IRISH WATER DOCUMENT "CODE OF PRACTICE FOR WATER INFRASTRUCTURE" IW-CDS-5020-03.
  - TYPICAL SERVICE LAYOUT DISTANCES TO BE AS PER IRISH WATER STANDARD DETAIL STD-W-11, STD-W-12, AND STD-W-12A.
  - WATERMAINS TO BE DECOMMISSIONED ARE TO BE CUT, CAPPED AND BURIED AT BOTH ENDS.

ALL INFRASTRUCTURE IS TO BE BUILT TO USICE EIREANN CODES OF PRACTICE AND STANDARD DETAILS

COPYRIGHT RESERVED. ALL DRAWINGS TO BE READ IN CONJUNCTION WITH ARCHITECTURE, STRUCTURAL ENGINEERS & MECHANICAL ENGINEERS DETAILS.

DO NOT SCALE DRAWING. USE FIGURED DIMENSIONS ONLY. ALL DISCREPANCIES TO BE REPORTED TO AKM DESIGN GROUP IMMEDIATELY. ALL DIMENSIONS TO BE CHECKED ON SITE BY MAIN CONTRACTOR PRIOR TO CONSTRUCTION. MAIN CONTRACTOR IS RESPONSIBLE FOR SET-OUT.

DESCRIPTION	REV	DATE
FIRST ISSUE	00	05/26

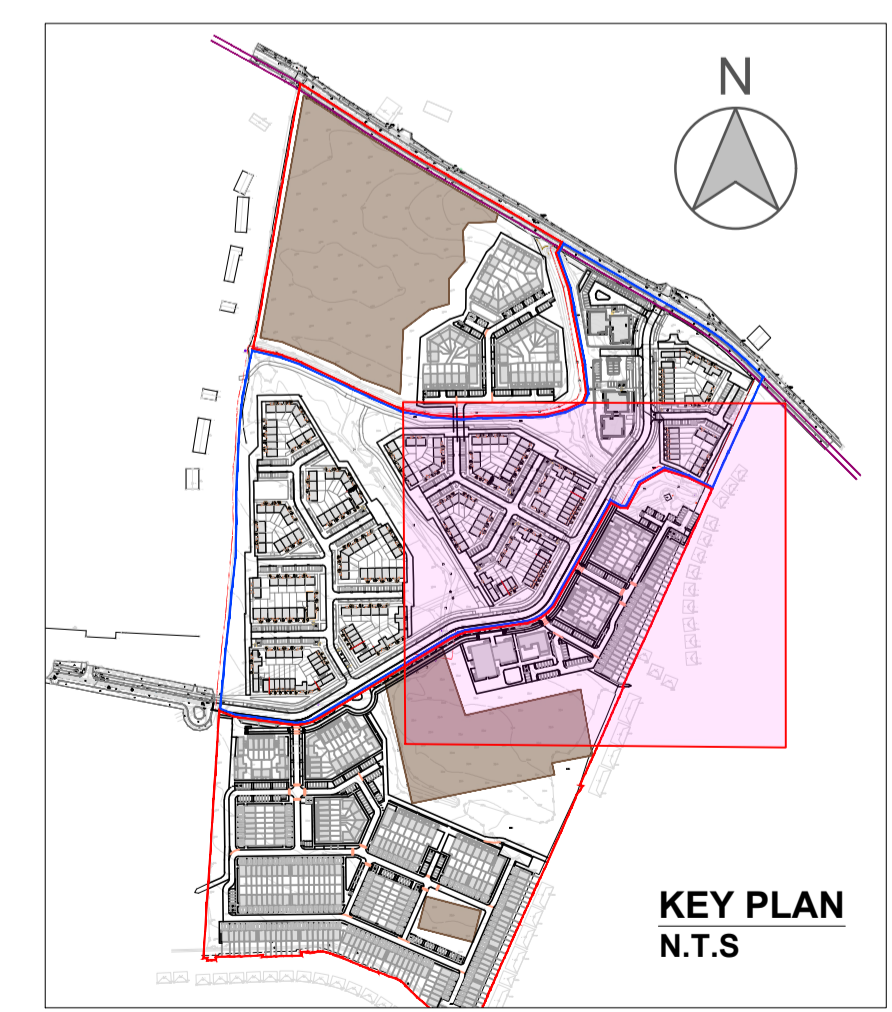

**AKM DESIGN GROUP.**  
Innovating tomorrow through design

14 Riverwalk, Citywest, Dublin 24, D24 XN32  
T: +353 1 479 6234 E: info@akmdesign.ie akmdesign.ie

STAGE:  
**S2 - FOR INFORMATION**

DRAWN BY: DM	APPROVED BY: CK	AKM JOB NUMBER: 25051
DATE: 05/26	SCALE: 1:500 @ A1	SEQUENCE NUMBER: 300007
REVISION NUMBER: 00		

DRAWING NUMBER:  
25051-AKM-XXXX-XX-DR-C01-300007

PROJECT TITLE:  
25051 - FINGAL MOORETOWN PHASE 2

DRAWING TITLE:  
PROPOSED WATERMAIN - SHEET 2 OF 3

CLIENT:  
FINGAL COUNTY COUNCIL

**PROPOSED WATERMAIN - SHEET 2 OF 3**  
SCALE 1:500